

RAFFTRIC MEZZO TECHNIQUE

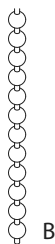
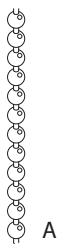
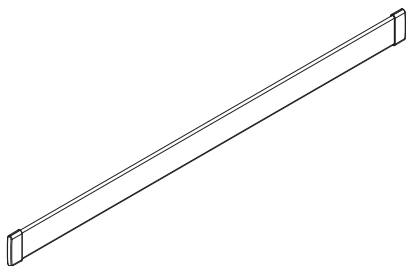
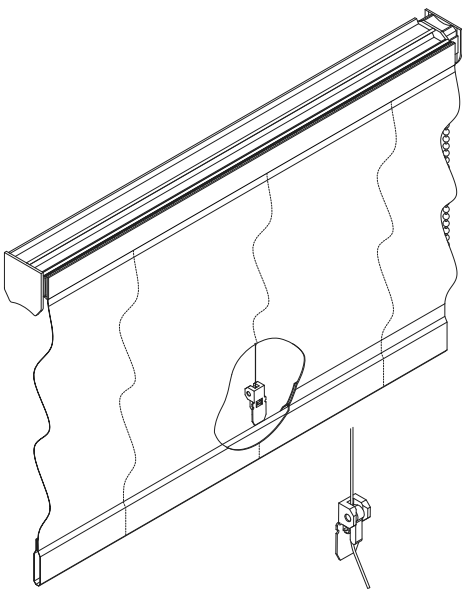
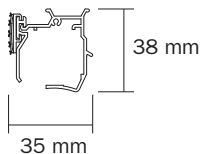
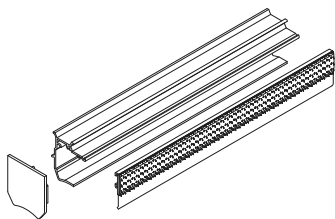
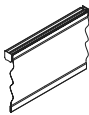

Profile Stable aluminium profile, 2 parts (head, cover hook-and loop-tape) for medium-weight and heavy roman blinds.

Curtains are quick and easy to remove for cleaning, thanks to the user-friendly click mechanism with cord-clip.

Colours Standard white RAL 9016
Standard anodized aluminium/grey

Size of system Width up to max. 300 cm
Height up to max. 300 cm

Weight of curtain Gear drive 1:1 max. 1,8 kg
Gear drive 1:3,5 max. 5,0 kg

Function Cord spool with cord clip for simple insertion and removal of draw cord

Bottom weight Flat aluminium profile 3 x 25 mm

Operation A Nickel-plated metal chain
B Plastic chain

transparent
white
grey

either right or left

weight of chain in stainless steel
INOX 90 weight 90 g
INOX 35 weight 35 g

Factory-made installation of endless-chain

RAFFTRIC MEZZO TECHNIQUE

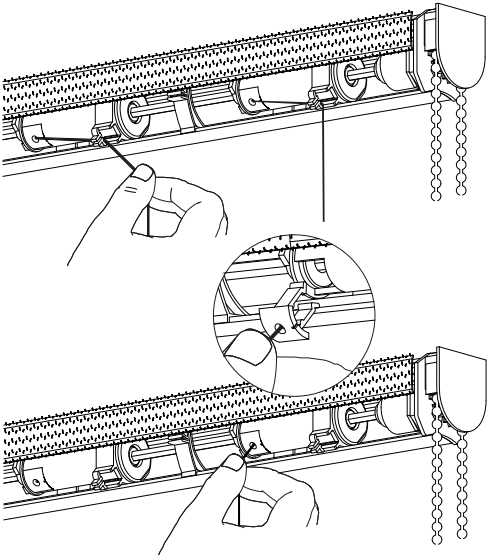
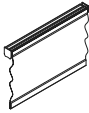

Cleaning the
curtain

- Take the curtain off the system
1. Pull the curtain completely down-wards and out
 2. Take the blind off the aluminium profile/hook-and loop tape at the top
 3. Take the cord out of the locking mechanism
 4. Pull the cord clip out of the cord spool

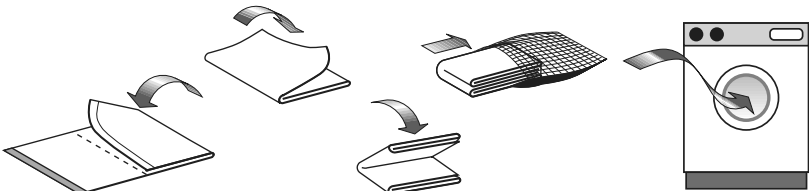

Wash the curtain

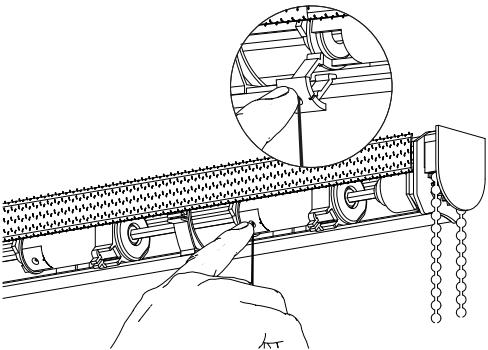

After washing:

1. Press the cord clip into the cord spool
2. Fit the cord into the locking mechanism
3. Fix the curtain onto the hook-and loop tape
4. The system is then ready to use

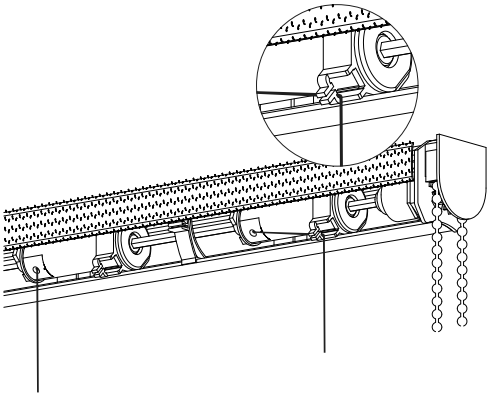

Width up to cm	90	130	170	210	250	300
Number of tapes	3	4	5	6	7	8
number of brackets	2	3	3	3	4	4

Arrangement of
tapes/brackets

RAFFTRIC MEZZO INSTALLATION

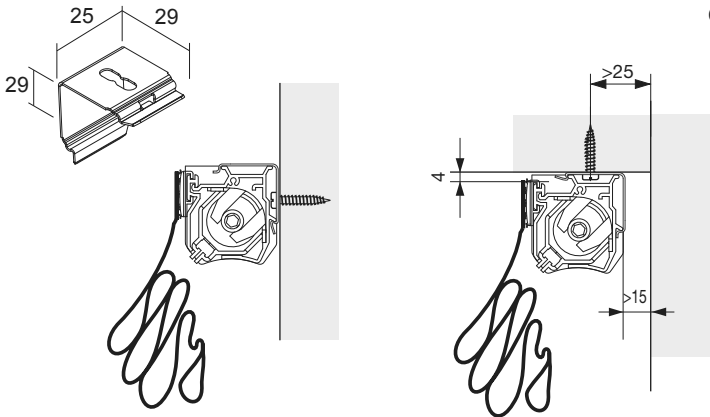
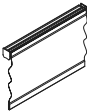

measure in mm

- Clip
 - Spring steel, for ceiling and wall instal-
lation
 - Colours
 - Standard stainless steel
 - Standard white

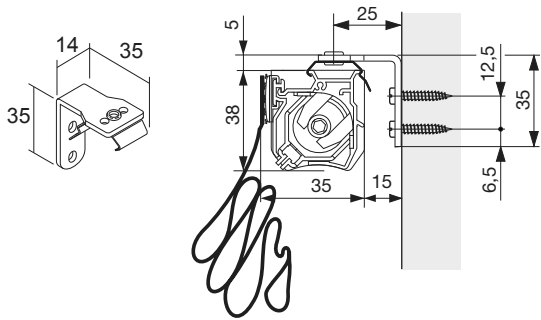

- Wall bracket
 - 25 mm
 - Metal, with pre-assembled clip
 - Colours
 - Standard galvanized
 - Standard white

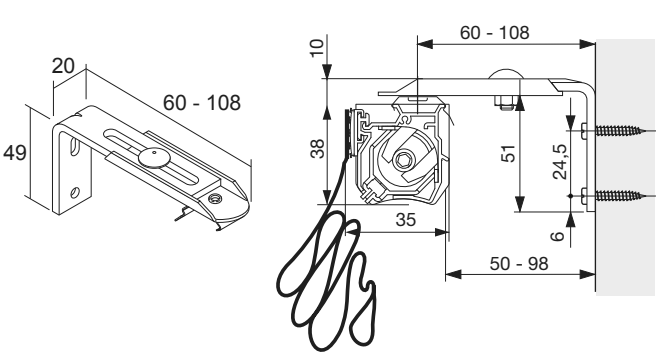

- Wall bracket
 - 60-108 mm
 - Metal, with pre-assembled clip
 - Colours
 - Standard galvanized
 - Standard white

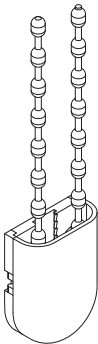

- SAFETY I
 - Chain tensioner for child safety,
keep chain out of the reach of children

RAFFTRIC PICCOLO / MEZZO
MAKING-UP ACCESSORIES

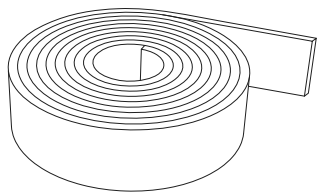

White polyamide hook-and loop tape,
washable, to sew on, width 20 mm

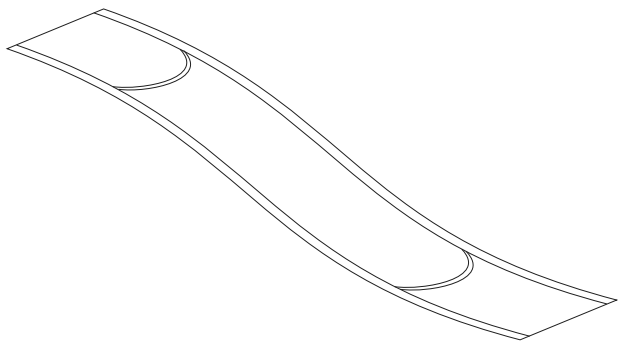

Loop tape, polyester transparent with
cross loops, 7.5 cm division, to sew on,
width 20 mm (making-up type A)

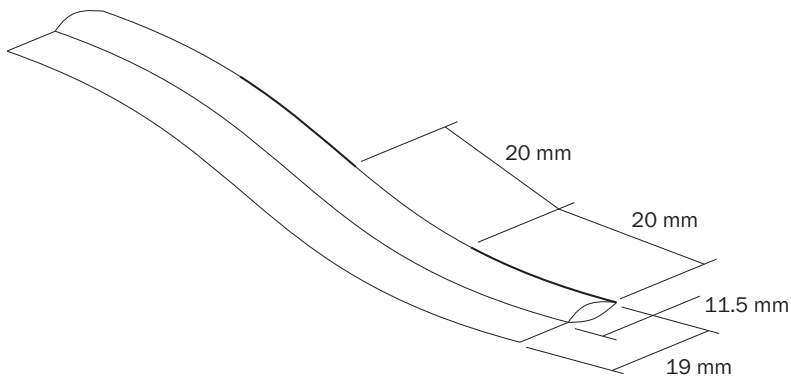

Insertion tape transparent for insertion
rod Ø 4 mm, width 19 mm
(making-up type B)

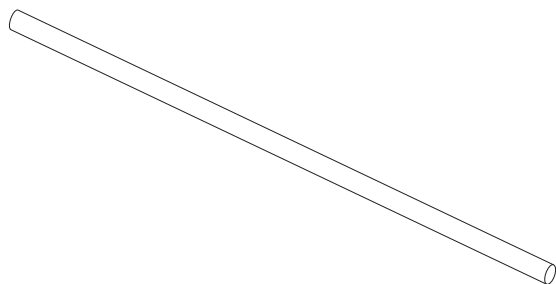

Insertion rod white, light and robust,
diameter 4 mm,
(making-up type B)

RAFFTRIC PICCOLO / MEZZO MAKING-UP ACCESSORIES



End cap for insertion rod Ø 4 mm
(making-up type B)
Colour white

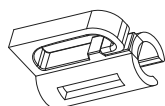

Clip insertion rod Ø 4 mm transparent
(making-up type B)

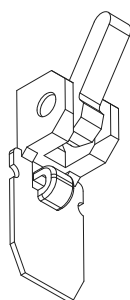

Transparent cord lock, to sew on

RAFFTRIC MAKING-UP

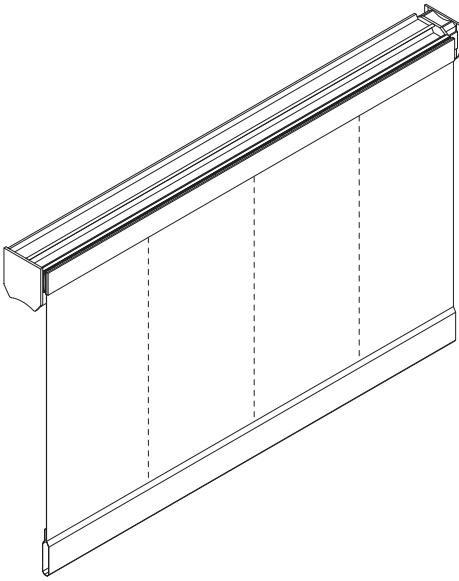

Making-up type A

RAFFTRIC
PICCOLO /
MEZZO

Reverse surface vertical sewn-on,
transparent loop tape
Distance segments
approx. 15 cm
Depth of fold approx. 7,5cm
Side seams approx. 6 cm, lower border
approx. 4 cm height
Weighting-flat aluminium profile,
3 x 25 mm

RAFFTRIC
MOBILE /
MOBILE S

Reverse surface vertical sewn-on trans-
parent loop tape
Distance segments approx. ca. 12 cm
Depth of fold approx. 6 cm
Side seams approx. 6 cm
Lower and upper border with loop tape

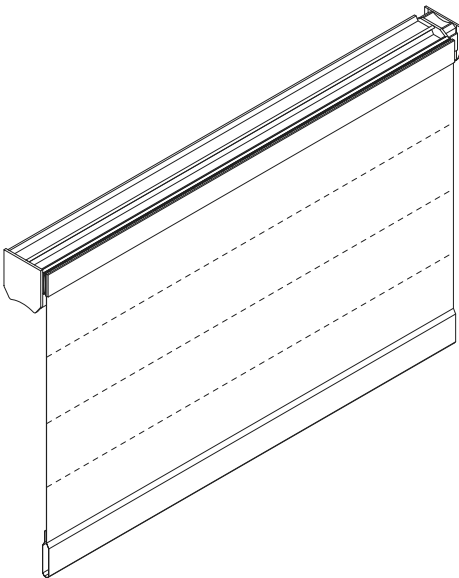

Making-up type B

RAFFTRIC
MEZZO

Reverse surface horizontal sewn-on,
transparent insertion tape
Robust circular insertion rod \varnothing 4 mm
Distance between segments
approx. 20 cm
Depth of fold approx. 10 cm
Side seams approx. 1.5 cm, lower bor-
der approx. 4 cm height
Weighting-flat aluminium profile
3 x 25 mm

RAFFTRIC
MOBILE /
MOBILE S

Reverse surface vertical sewn-on trans-
parent insertion tape
Robust circular insertion rod \varnothing 4 mm
Distance segments approx. ca. 15 cm
Depth of fold approx. ca. 7.5 cm
Side seams approx. 1.5 cm
Lower and upper border with loop tape

Curtain stack on top:
Abt. 15–20% of the height of curtain
(depending on the kind of fabric and
type of making up)

MEASURING AND INSTALLATION

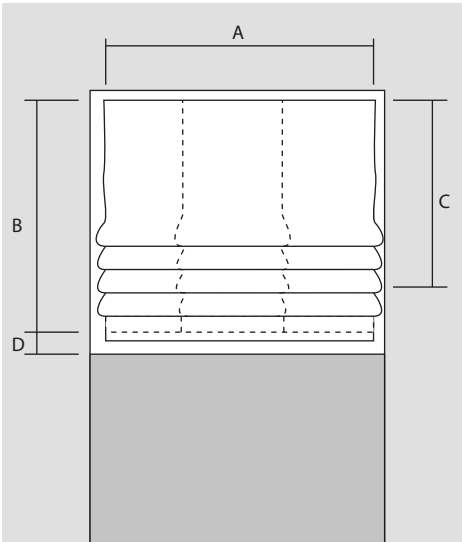

Installation in the
niche
RAFFTRIC
PICCOLO/
MEZZO

- A – width of system = width of niche – 10 mm
- B – height of system = height of the niche
- C – length of draw
- D – clearance

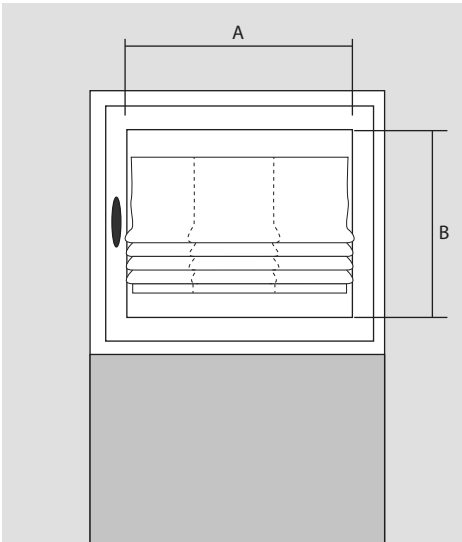
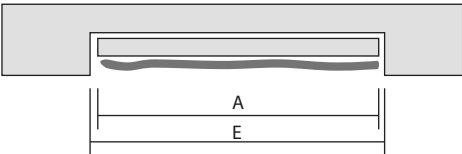

Installation in
support
window bar
RAFFTRIC
MOBILE/
MOBILE S

- Please take notice of the system depth of 22 mm by installation in the recess of the support window bar
- A – width of system = width of glass – 5 mm
 - B – height of system = height of glass – 5 mm

MEASURING AND INSTALLATION

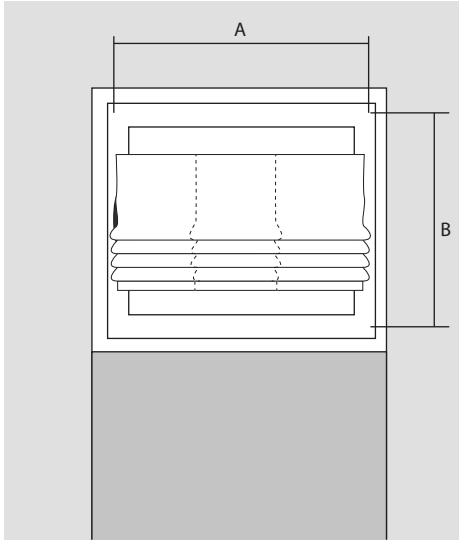

Frontal installation on window frames

RAFFTRIC
MOBILE/
MOBILE S

Wall support:

- A – Width of system = width of glass + desired overlap
- B – Height of system = height of glass + desired overlap

Clamping carrier:

- A – Width of system = width of glass + desired overlap
- B – Height of system = height of window frame

Support window bar:

- A – Width of system = measure of the leading edge + desired overlap (2x width of support window bar)
- B – Height of system = measure of the leading edge + desired overlap (2x width of support window bar)